

Forest Hills Cemetery

Town of Bridgton, Maine

Plan View 2010

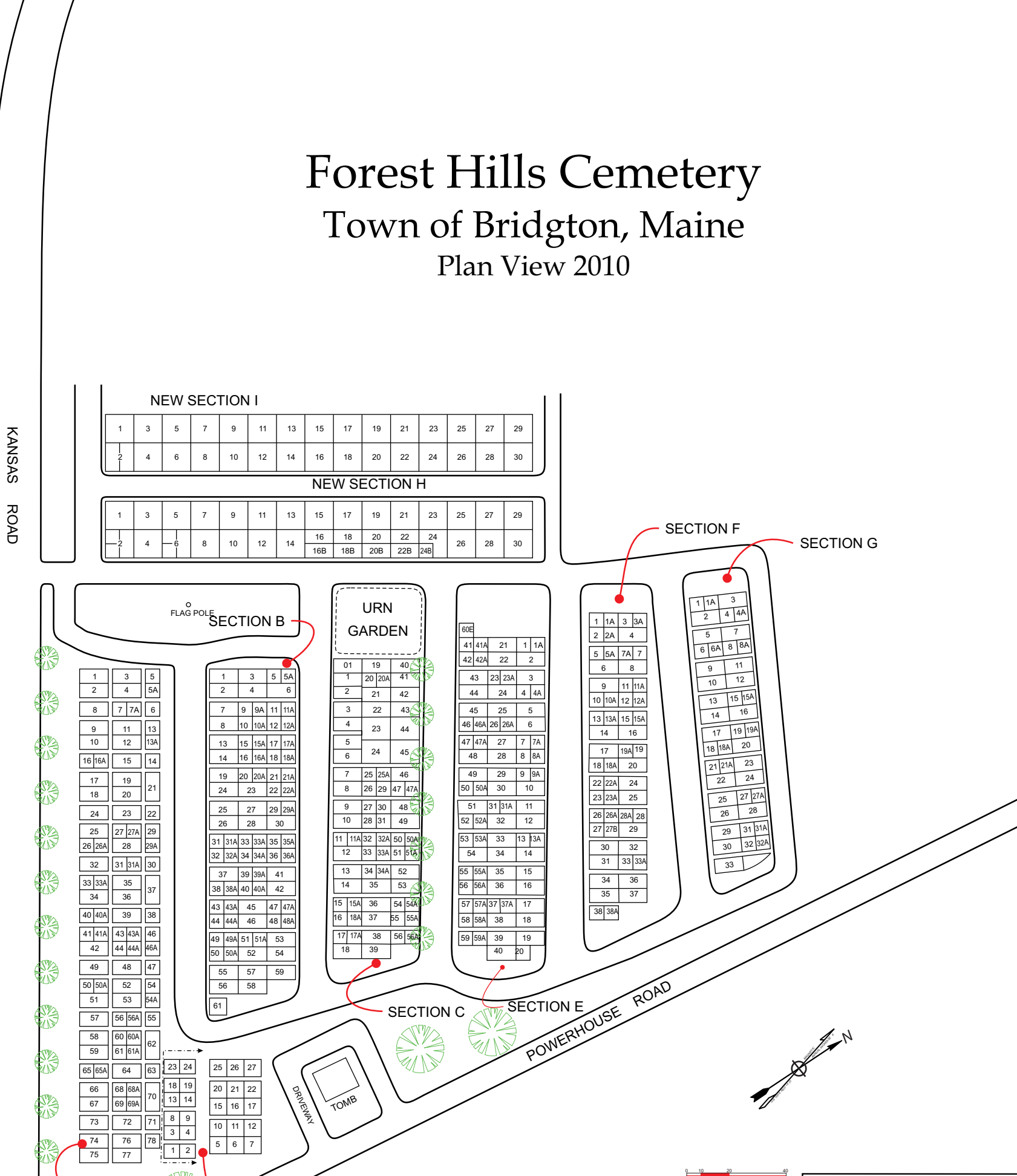

Original plan draw by:
Ray T. McDonald Surveyor
November, 1952

A	E
B	F
C	G
D	H

1992 Legend
N.S.: Not Sold
D.K.: Don't Know

Lot numbers 3, 5, 9, 11, 13, 15, 17, 19, 23, 25, 27, & 29 on Carnation Ave are to be divided into single graves as shown above

Names copied from previous plan.
July 13, 1992
R.C. Green, Jr

BOOK 39

SCALE: 1" = 40'



Disclaimer: The contents of this map is based on documents and information supplied by the client and public satellite imaging. Accuracy of images is not suitable for engineering purposes. TOPOGRAPHIX assumes no responsibility for it's content.

Forest Hills Cemetery

Plan View

NOTE: The scale, grave location and measurements shown are for general reference use only. This is not a site surveyed document.

Scale 1" = 40'

Sheet 1 of 8

Copyright © 2010 by TOPOGRAPHIX, LLC

PROPERTY LINE

CARNATION AVENUE

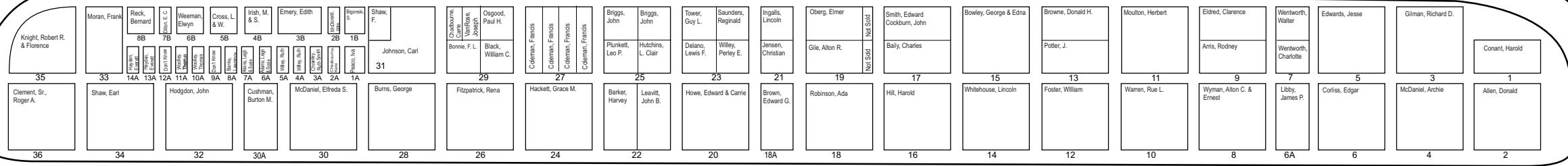

HYACINTH AVENUE

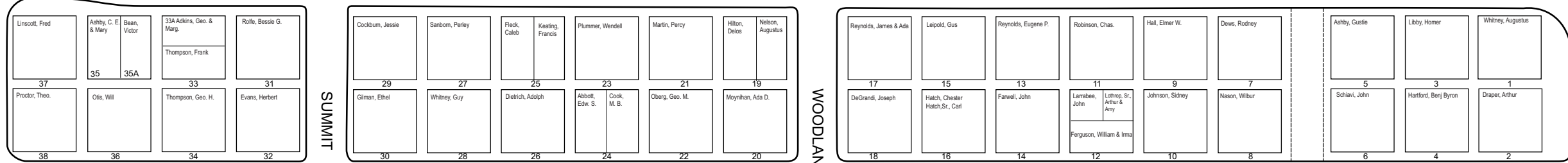

PRIMROSE AVENUE

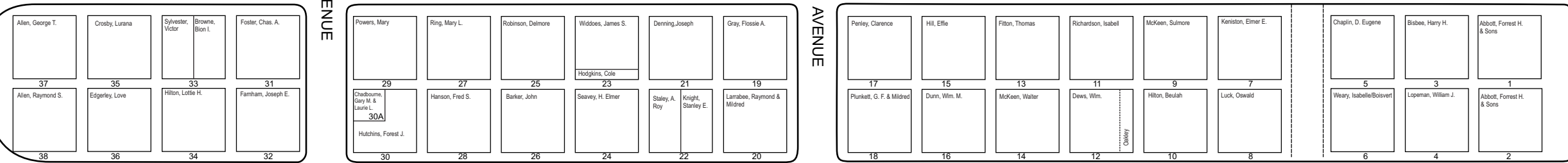

SMILAX AVENUE

SUMMIT AVENUE

WOODLAND AVENUE

FRONT AVENUE

KANSAS ROAD



Disclaimer: The contents of this map is based on documents and information supplied by the client and public satellite imaging. Accuracy of images is not suitable for engineering purposes. TOPOGRAPHIX® assumes no responsibility for it's content.

PROPERTY LINE

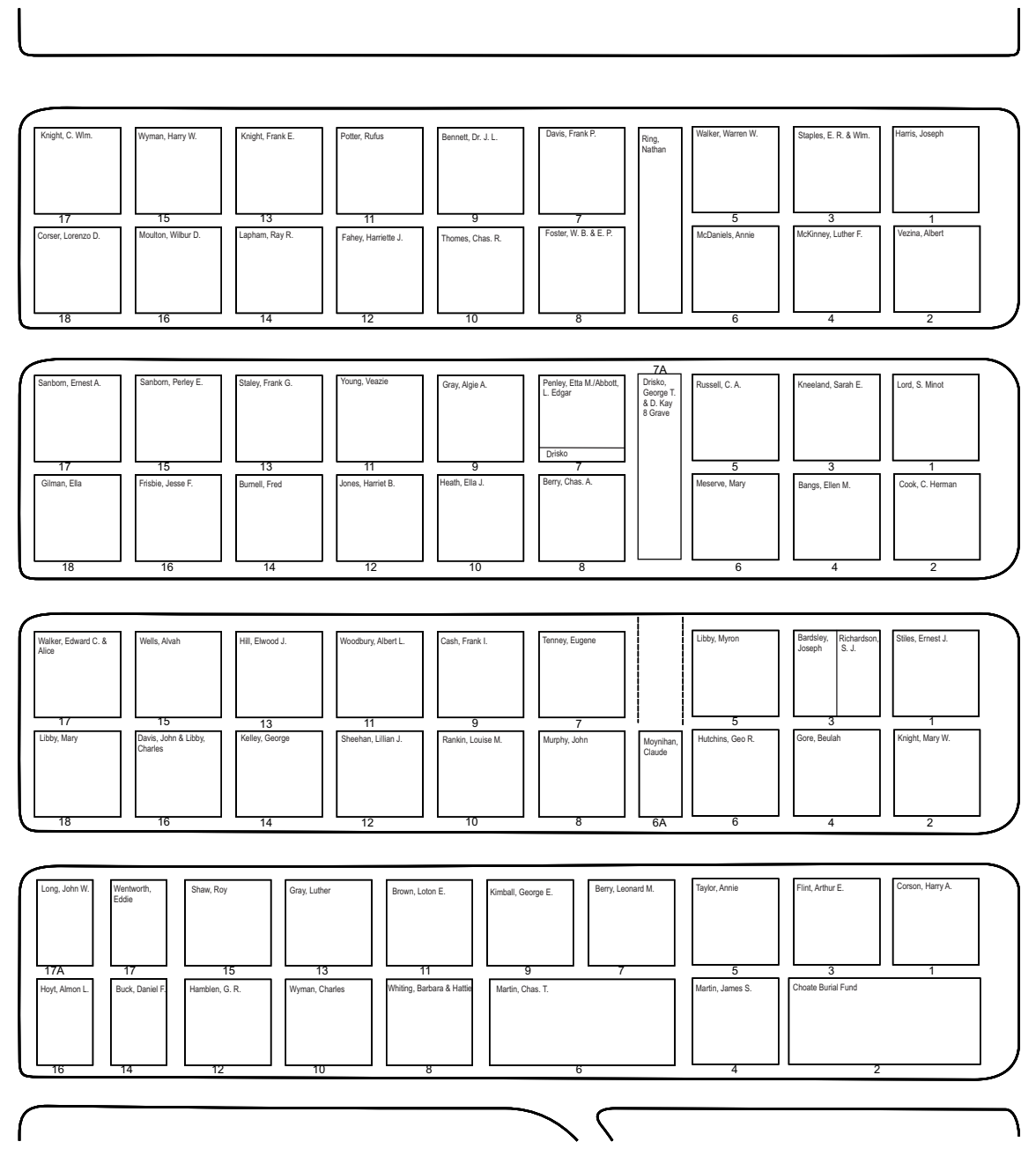
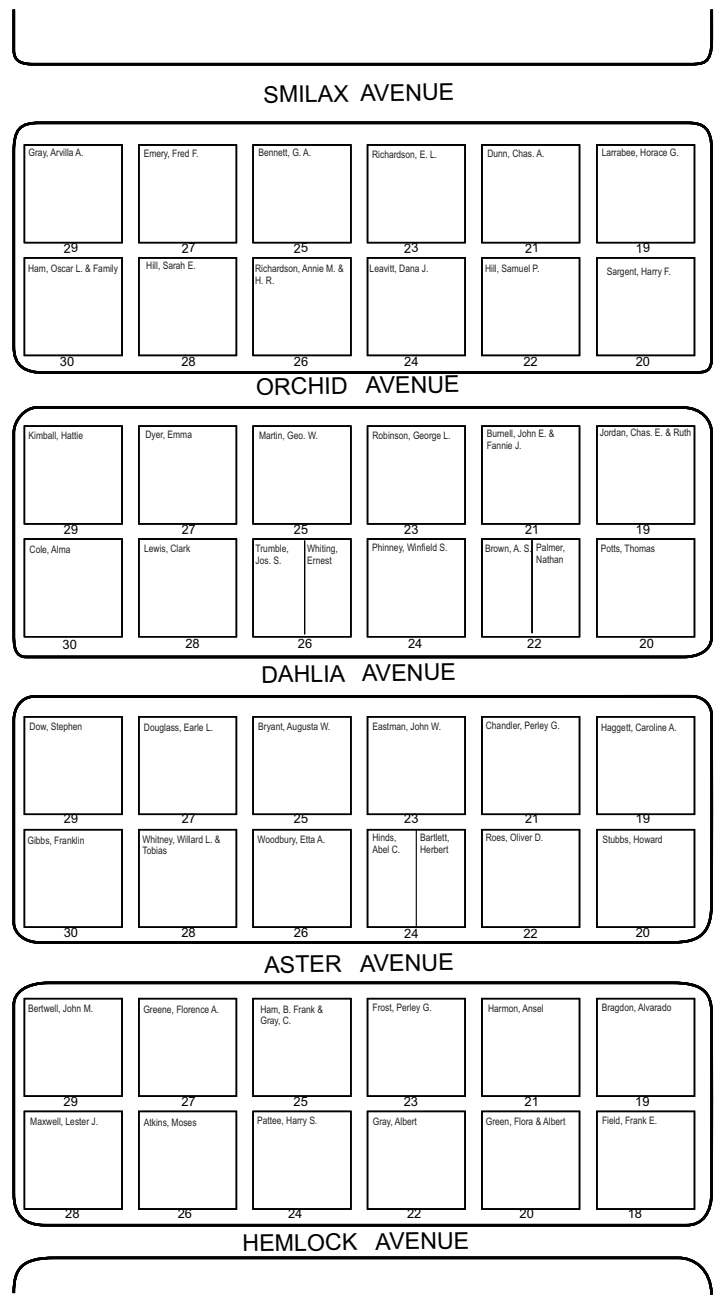
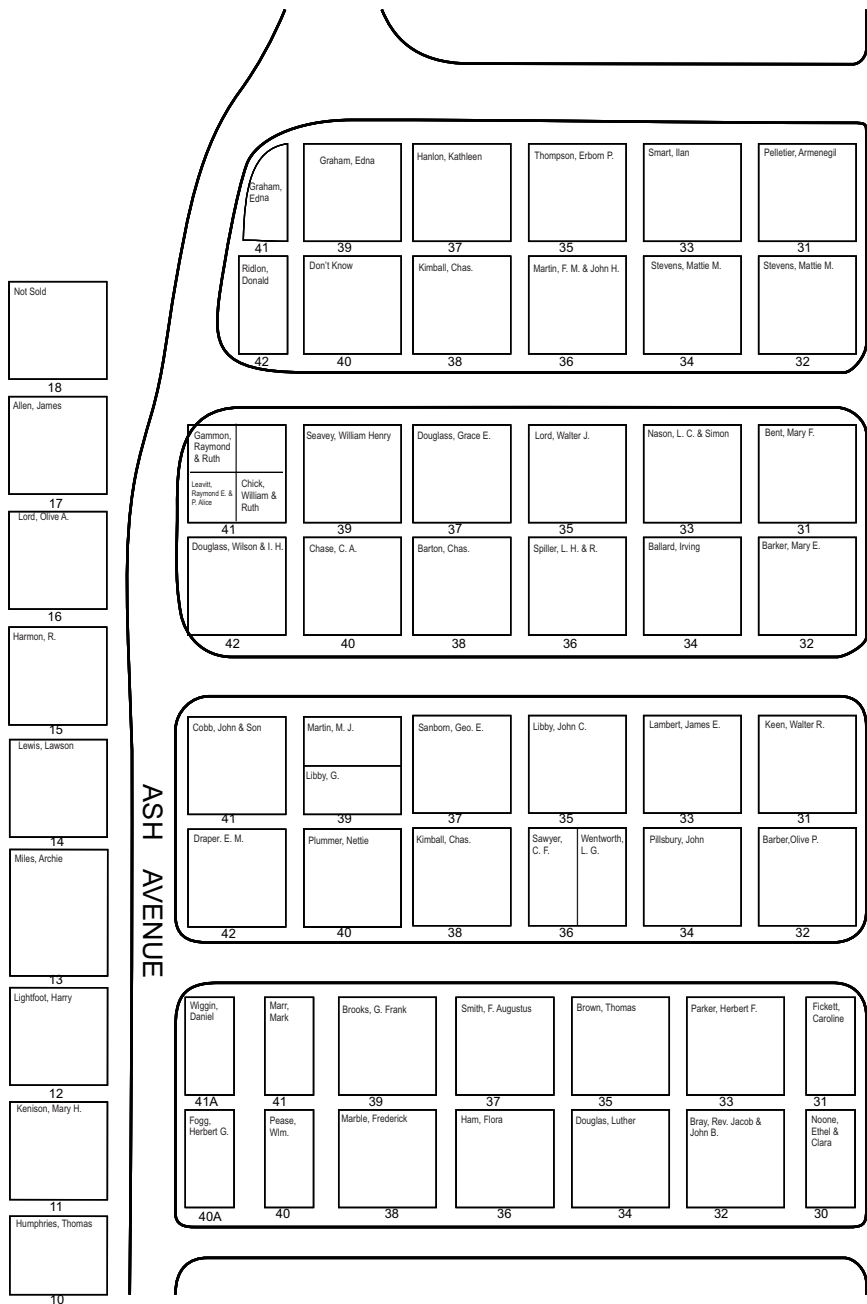

KANSAS ROAD

FRONT AVENUE



Disclaimer: The contents of this map is based on documents and information supplied by the client and public satellite imaging. Accuracy of images is not suitable for engineering purposes. TOPOGRAPHIX® assumes no responsibility for it's content.

Forest Hills Cemetery	
Section View	
NOTE: The scale, grave location and measurements shown are for general reference use only. This is not a site surveyed document.	Scale 1" = 20'
Sheet 3 of 8	
Copyright © 2010 by TOPOGRAPHIX, LLC	

PROPERTY LINE

- 10 Humphries, Thomas
- Allen, Edward S.
- 9 Allen, James B.
- 8 Bowley, Linus
- 7 Eastman, Roger
- 6 Hatch, Ruth
- 5 Allen, Arnold J.
- 4 Town

HEMLOCK AVENUE

Carnell, Eben H.	Scribner, Allen P.	Walker, Asaph	Seavey, Frank W.	Paine, Adaline	Larabee, Frank M.
39 Hale, George F.	37 Douglass, Levi	35 Plummer, Freeman W.	33 Larabee, Geo. H.	31 Butlers, Levi	29 Stevens, Frank & Eva
40	38	36	34	32	30

HEMLOCK AVENUE

Mitchell, John, Rev.	Gleason, Micajah	Gibbs, Charles B.	Gibbs, Aaron	Smith, Parley W. & Alberta	Simpson, Frank B.	Barnett, Joshua F.
27 Lewis, Nelson & Francis	25 Bertwell, Chas. E.	23 Hazen, Walter S.	21 Martin, Enoch	19 Smith, Lewis	17 Kimball, Wm. G.	
28	26	24	22	20	18	

WOODLAND AVENUE

Harry, Alfred E.	Duffee, Aidana	Hewson, William	Dodge, Richard	Brown, Theodore	
15 Taylor, George W.	13 Pomeroy, Harold	11 Gray, Frank	9 Drowns, Edwin L.	7 Edmunds, Vertude A.	5A Luperman Jr. Wm.
16	14	12	10	8	8A

WOODLAND AVENUE

Berry, James E.	Chamberlain, E. C.	Halkett, J. Henry	Garrison, Jefferson C.
5A Not Sold	5 Bacon, Eva & Mary	3 Carmen, Luther S.	1 Bennett, Reuben
6A	6	4	2

SUMMIT AVENUE

Small, William	Johnson, Cyrus C.	Hamblen, John G.	Scribner, David M.	Holt, William	Burnham, Eta M.	Wight, Geo. G.
39 Morrison, John	37 Ingalls, Herbert	35 Shaw, Wm. H.	33 Adams, Leon S.	31 Roes, John H.	29 Saunders, David C.	25 Parley, Geo. P.
40	38	36	34	32	30	

FOUNTAIN AVENUE

Allen, Samuel R.	Davis, Sumner C.	Brown, Geo. H.	Libby, Wm. M.	Brown, Walter	Martin, Ada F.	Morrison, Wm. A.	Dickens, Fred
27 Buck, Walter	25	23 Chadbourn, Philip	21 Bradstreet, Geo.	19 Howard, Barzila	17 Howard, B. Page	Larabee, Wm. H.	
28	26	24	22	20	18		

WOODLAND AVENUE

Jenner, James	Trumbull, Carl	Brill, Gordon W. & John D.	MacDonald, Frank T.	Packard, George Henry
15 Wales, Joseph	13 Burnham, Nathan C.	11 Clark, Samuel D.	9 Burnham, Frank H.	7 Topham, William
16	14	12	10	8

WOODLAND AVENUE

Taylor, George	Keene, John	Corson, Walter
5	3	1
6	4	2

CHAPEL AVENUE

Hanson, Frank D.	Merrill, Austin P.	Merrill, Thatcher P.	Chaplin, David P.	Cheatham, John
39 Bacon, Geo. S.	37 Stone, Simon	35 Stone, John & Essie	33 White, Leander M.	31 Leavitt, Joseph S.
40	38	36	34	32

CHAPEL AVENUE

McDonald, Wm. M.	Hilton, Lizzie E.	Chase, Chas. H.	Freeman, Geo. W.	Newcomb, Geo. W.
27 Stevens, Della A.	25 Merrill, Amasa H.	23 Stevens, Berj. W.	21 Dodge, Nathan C.	19 Sylvester, Aaron
28	26	24	22	18

WOODLAND AVENUE

Potter, Charles	Hariman, Abel	Martin, Leonard	Iredale, William	Perry, William F.
15 Ballard, Josiah	13 Mellor, Richard	11 Fogg, Clara G.	9 Crockett, Daniel M.	7 Castle, John
16	14	12	10	8

WOODLAND AVENUE

Burns, Geo. E. & Annie	Clark, Allen P.	Allen, Isaac
5 Hazen, David P.	3 Proctor, Kenneth A.	1 Plummer, Orrin G.
6	4A	4

CHAPEL AVENUE

Paine, Fred	Baker, Theophilus & Cyrus	Gomersall, William	Keele, Joseph	Littlefield, Blanche B.
42	40	38	36	34
43	41	39	37	35

OAK AVENUE

Taylor, H. H. & Sarah	Wigt, Ronell L.	Stedman, Wm. H.	Ingalls, Owen B.	Ross, Carsten
27	25	23	21	19
28	26	24	22	20

WOODLAND AVENUE

Webb, Isaac	Mellor, Joseph Thomas	Jennings, Chas.
17	15	13
10	8	6

WOODLAND AVENUE

Easton, Thomas N.	Manner, Frederick W.	Don't Know
5 Haskell, Wm. L.	3 Vince, James H. & Ellen	1 Whitney, Fred
6	4	2

CHAPEL AVENUE

Douglass, Daniel & Samuel	Lord, Clayton S.	Blosson, Walter	Marcoue, John A.	Kimball, John	Douglass, Marshall & Knox	Thyphens H.	Douglass, Albert	Brown, Chas. W.	Winstow, C. W.	Weymouth, Stephen	Plaker, Joseph P.	Simon, Chas.	Green, Granville P.	Green, Abrizo	Gardner, Jerry W. & Joan	Scotchard, Rowana	Field, John	Not Sold	Don't Know
43	41	39	37	35	33A	33	31	29	27	25	23	21	19	17	15	13	11		

MAPLE AVENUE

Foster, Julia E.	Trumble, Walter	Balford	Fogg, James A.	Long, Walter D.	Boom, Herbert H.	Smith, Geo. F.
21	19	17	15	13	11	9
30	28	26	24	22	20	18

WOODLAND AVENUE

Nicholson, Geo. Knight	Jackson, James	
7A	5A	
Douglass, Lincoln	Douglass, Geo. W.	Robbins, Frank
9	7	6A
Douglass, Earl	Saunders, Wm. P.	Morrell, Walter
18	16	6B
16A	14A	8A
		Woolley, LaForest
		10A
		10

MAPLE AVENUE

Robinson, Greenleaf	Chadbourne, Lyman B.	Burnham, Albion H.
5	3	1
6	4	2

BIRCH AVENUE

Gardner, Jerry W. & Joan	Field, John	Not Sold	Don't Know
17A	15	13	11

BIRCH AVENUE

Wills, Stanley P.	Pennell, Clarence R.
10A	8
10	8

WOODLAND AVENUE

Allen, Jr., Robert	Snow III, Everett Frank & Snow, Dorothy I.
2	3

GLEN AVENUE

Taylor, Geo. & Arty, Charles	Green, Geo. S. & Juna	Irish, Chas. H.
5	3	1
6	4	2

BIRCH AVENUE

McCormick, Harvey	Buswell, John	Walker, Edward	Trush, A.	Unknown	Reynolds, James	Leighton, D. H.	Not Sold
9A	9	7A	7	5	3	1	1A

BIRCH AVENUE

McComick, Harvey	Buswell, John	Walker, Edward	Trush, A.	Unknown	Reynolds, James	Leighton, D. H.	Not Sold
9A	9	7A	7	5	3	1	1A

WOODLAND AVENUE

McCormick, Harvey	Buswell, John	Walker, Edward	Trush, A.	Unknown	Reynolds, James	Leighton, D. H.	Not Sold
9A	9	7A	7	5	3	1	1A

BIRCH AVENUE

McCormick, Harvey	Buswell, John	Walker, Edward	Trush, A.	Unknown	Reynolds, James	Leighton, D. H.	Not Sold
9A	9	7A	7	5	3	1	1A



KANSAS ROAD

75 Medbury, Sawyer E. & Elizabeth I.	74 Medbury, Sawyer E. & Elizabeth I.	73 Potts, Hattie E.	67 Cross, Eleanor M. & Eastman	66 Cross, Eleanor M. & Eastman	65 Thomas, David R. & Kathryn H.	59 Clements, Benjamin R. & Ruth C.	58 Clements, Benjamin R. & Ruth C.	57 Kimball, Doris G.	51 Mowatt, Sr. Arthur	50 Rebok, Shelbourne	49 Parsons, Ernest G.	42 Morgan, Evelyn G.	41 Wood, Arlene M. & Dolores C.	40 Widon, Grace G.	34 Ridon, William	33 Nilson, Roy S.	32 Cushman, Sr. Guy B.	26 Browning, J. Douglas & Shirley L.	25 Gardner, Arnold A.	24 Fleck, C.	18 Pike, Sr., Frank H.	17 Pike, Sr., Frank H.	16 Klackner, George & Ernestine	10 Crosby, Leon & Mildred	9 Crosby, Leon & Mildred	8 O'Brien, Lena A.	2 Swanson, John H. & Elsa B.	1 Swanson, John H. & Elsa B.
77 Clark, Lonelle J. & Robert S.	76 Hogan, Cecil	72 Thompson, A.	69 Hanley, John E.	68 Brooks, Barbara	64 Wile, John D. & Mary E.	61 Hansen, H.	60 Stone, Pauline	56 Graffam, James & Eliza	53 Boyd, David S.	52 Shaw, Lawrence R.	48 Larabee, Beatrice H.	44 Keene, Harmon B.	43 Stevens, Hannah	39 Allen, Sr., Lawrence F.	36 Pettit, Lawrence G. & William R.	35 Perry, J. R. & Katherine M.	31 Cobb, Roger M.	28 Davis, Roger I. & Ellen F.	27 Potter, Fernando M.	23 Graham, Albert	20 Mayberry, Ernest H. & Hazel B.J.	19 Ricker, Grace A.	15 Phelps, R. S.	12 Barker, Clifford H. & Margaret	11 Miller, Kenneth & Margaret	7 Smith, Etta E.	4 Wagner, Isaiah	3 Wagner, Isaiah
78 Smith, Mabel O.	71 Wilkins, Marion P.	70 Hoover, Willis A. & Myrtle E.	63 Hatch, Marilyn	62 Hatch, Marilyn	55 Thompson, Russell W. & Elaine D.	54A Hatch, Carl & Doris	54 Loperman, Arthur & Beulah	47 Benjamin, Frances Hart	46A Douglas, Linwood	46 Burnell, I. Lincoln & Bernice	38 Dubreuil, George W. & Ethlyn M.	37 Hardy, Edith	30 Reynolds, Marie R. & Vivian H.	29A Palma, Frank & Mollie	29 King, George R. & Almeda M.	22 Smith, Raymond Y.	21 Allen, Alvarado & Lillian	14 Douglas, Max E. & Virginia M.	13A Barker, Clifford H.	13 Hains, Leo J. & Gladys E.	6 O'Brien, Donald E. & Phyllis J.	5A Gagnon, Alida	5 Oamond, Alice R.					

SECTION A

1 Morrison, Earl & Jennifer	3 Smith, Bruce	8 Nowell, Barbara J.	13 Sirois, Romeo	18 Rolfe, Michael	23 Smith, A.
2 Morrison, Larry & Evelyn	4 Salye, Harold W. & Josephine	9 Nowell, Barbara J.	14 Smith, Curtis	19 Stone, M.	24 Uhyk, Jeanne

5 Morrill, Roger & Judy	10 Cross, Milton & Betty	15 Rehn, Harry	20 Cannell, Warren & Dorothy	25 Morgan, George & Mildred
6 Gargant, Thurston & Josephine	11 Gargant, Thurston & Josephine	16 Durfee, Curdilo	21 Cannell, Warren & Dorothy	26 Stuart, Kenneth & Phoebe
7 Prentice, Sheldon & Patricia	12 Prentice, Sheldon & Patricia	17 Bryant, Keith	22 Cannell, Warren & Dorothy	27 Stuart, Kenneth & Phoebe

SECTION D

61 Clemons, LeRoy	56 Stevens, Lois M.	55 Stevens, Lois M.	50 Newcomb, Gertrude	49 Haggitt, Jeannette	44 Blanchard, Catherine T.	43 Stackhouse, June	38 Chadbourne, Delmar & Phyllis	37 Cadman, Gwendolyn	32 Burkusky, Anne E. & Jerome Richard & V. Anne	31 Burkusky, Anne E. & Jerome Richard & V. Anne	28 Richardson, H. Dale	25 Richardson, H. Dale	24 Gray, David F. & Dorothy A.	19 Gray, David F. & Dorothy A.	14 Allen, Stanley E. & Victoria A.	13 Macdonald, Roger W.	8 Macdonald, Roger W.	7 Macdonald, Roger W.	2 Gallinari, Antonio	1 Gallinari, Antonio
58 Stevens, Lois M.	57 Stevens, Lois M.	52 Diller, David	51 Shaw, Robert & Hazel	48 Cardoso, Anna	45 Cardoso, Anna	40 Disko, Arthur	39 Sinclair, Violette	34 Fitch, Michael	33 Staley, Delma	32A Staley, Delma	28 Durkin, William	27 Durkin, William	23 Grave, Tsp. Clara & Robert	20 Tsp. Clara & Robert	16 Douglas, Max E.	15 Richardson, L.	10 Halvorsen, Kaare	9 Lane, Nancy	4 McNeil, Jr., Samuel F.	3 McNeil, Jr., Samuel F.
59 Roberts, Elizabeth & Mildred	54 Graffam, Wayne R. & Kathy	53 Harmon, Eben	48 Libery, El	47 Rutana, Ruth E. & Victor W.	42 Trumble, Leamon & Frances	41 Brill, Stephen	38 Doyle, William L.	35 Carr, Arthur & Helen	34 Fitch, Claudia	33A Gilbert, George F.	30 Smith, Carlton & Phyllis	29 Smith, Carlton & Phyllis	22 Wheaton, Ruth	21 Wheaton, Ruth	18 Beech, Nora. Robert & Helen	17 Edson, Chesley	12 Fadden, Reginald J. & Edna L.	11 Fadden, Reginald J. & Edna L.	6 Clement, Fred W. & Shirleyann	5 Doney, Bertha G.

SECTION B

18 Allen, Gail	17 Van Rose-Hubbard, Charlotte	16 Morrissette, William L.	15 Brown, Edmund	14 Bosworth, John E.	13 Woodruff, Archibald M.	12 Thurlow, Fred C. & Verma M.	11 Brackett, Frances	10 Davis, Paul V. & Marguerite B.	9 Davis, Paul V. & Marguerite B.	8 Berg, John J.	7 Allen, Jr., Lawrence F. & Eleanor	6 Mowatt, Camilla	5 Mowatt, Gordon	4 Mowatt, Sr. Harley H.	3 Gallinari, Paul	2 Gallinari, Joseph L. & Olga	1 Gallinari, Joseph L. & Olga	01 Staley, Robert & Debra
39 Barber, Stevens & Mary & Simmwell, Susan Thomas	38 Barber, Stevens & Mary & Simmwell, Susan Thomas	37 Harrison, Avina	36 Harrison, Avina	35 Barker, Edwin K. & Ruby	34 Cook, LinnMentl	33 Martin, Richard	32 Martin, Richard	28 O'Connell, Christine	27 Whiting, R.	26 Fitzcharles, William	25 Carlson, Charles & Nancy	24 Shepard, Alan & Marguerite	23 Shepard, Alan & Marguerite	22 Leland, William A. & Ellen	21 Porter, Michelle	20 Abrecht, William	19 Abrecht, Alan	
56 Griffin, Marlene & Robert	55 Hanson, Avina	54 Hanson, Avina	53 Lane, Arnold S. & Lois M.	52 Lane, Arnold S. & Lois M.	51 McAninch, Judy	50 Frazier, Stanley	49 Hansonford, Wesley & Phyllis	48 Julien, Claire	47 Franchek, J.	46 Norton, Michael J.	45 Brant, Clifton	44 Brant, Clifton	43 Hanson, Barbara	42 Barry, Marilyn	41 Davis, Harlan	40 Davis, Harlan		

SECTION C

FLAG POLE ○

URN GARDEN

POWERHOUSE ROAD

DRIVEWAY

TOMB



Disclaimer: The contents of this map is based on documents and information supplied by the client and public satellite imaging. Accuracy of images is not suitable for engineering purposes. TOPOGRAPHIX assumes no responsibility for it's content.

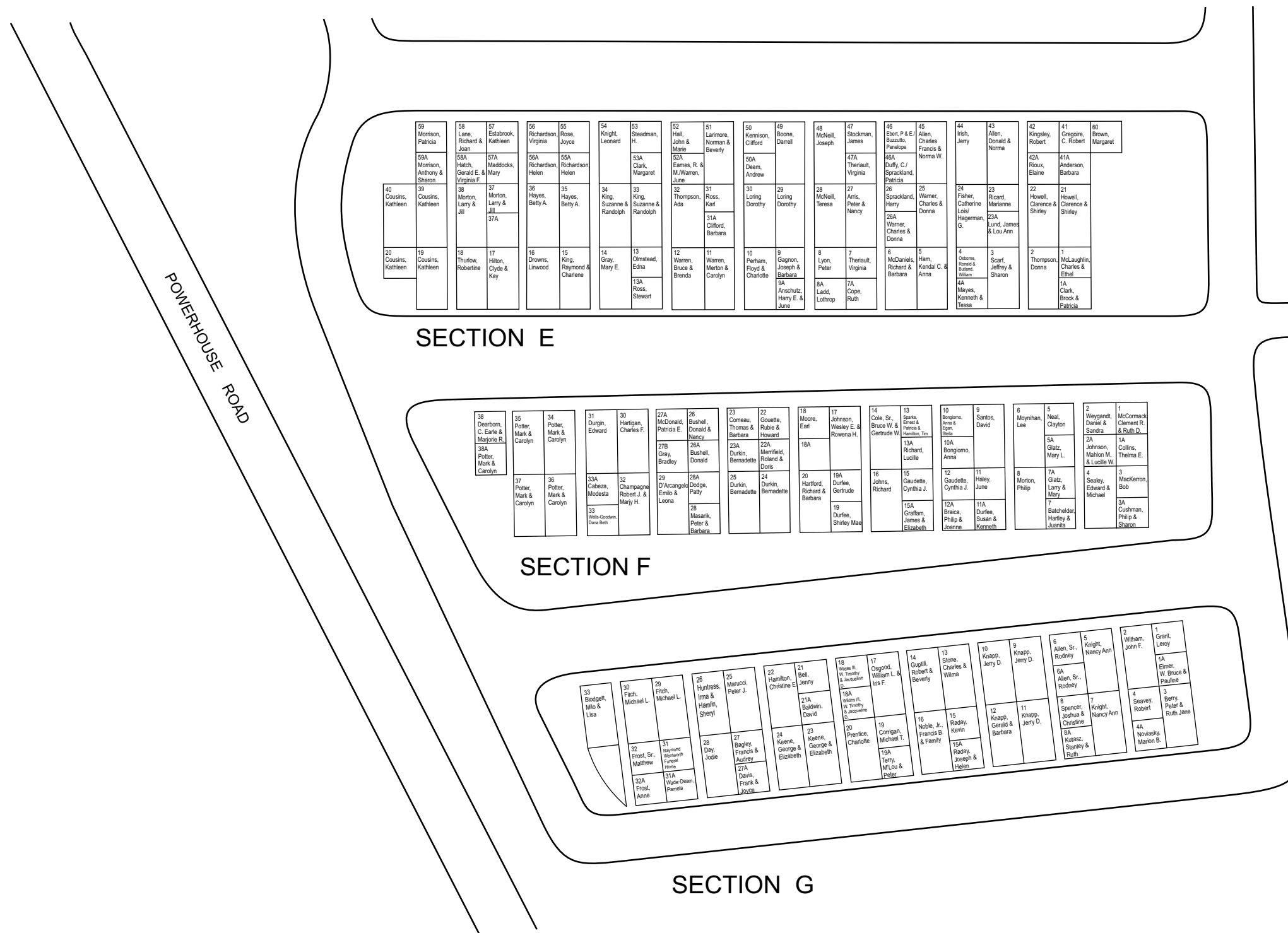

Disclaimer: The contents of this map is based on documents and information supplied by the client and public satellite imaging. Accuracy of images is not suitable for engineering purposes. TOPOGRAPHIX® assumes no responsibility for it's content.

Section - W

Section - X

PEARL AVENUE

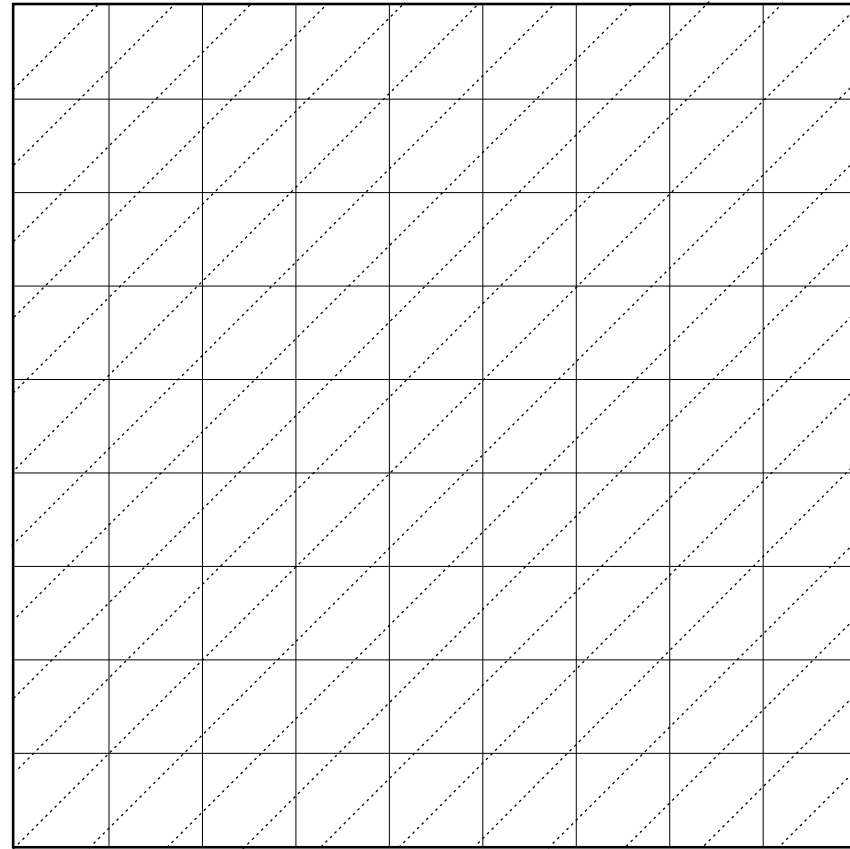

Walk Path

Reid, Heidi								Linscott, Patricia
Y73	Y74	Y75	Y76	Y77	Y78	Y79	Y80	Y81
Y64	Y65	Y66	Y67	Y68	Y69	Davis, Joyce & Bulley, Leon	Y71	Y72
Y55	Y56	Y57	Y58	Y59	Y60	Y61	Y62	Maczuba, Jan & Carol
Y46	Y47	Y48	Y49	Y50	Richards, Alma R.	Gelles, Norma F. & Robert	Y53	Y54
Y37	Y38	Y39	Y40	Y41	Y42	Y43	Y44	Y45
Y28	Y29	Y30	Y31	Y32	Y33	Y34	Y35	Henning, Carl & Doris
Y19	Y20	Y21	Y22	Y23	Y24	Y25	Y26	Y27
Y10	Y11	Y12	Y13	Y14	Y15	Y16	Y17	Y18
Eileen & Francis Russo		Chapman, Jr. George R. & Faylene M.		Adams, Cheryl				Angelo, Priscilla & Joseph W.
Y1	Y2	Y3	Y4	Y5	Y6	Y7	Y8	Y9

Walk Path

Sitting Area

Walk Path

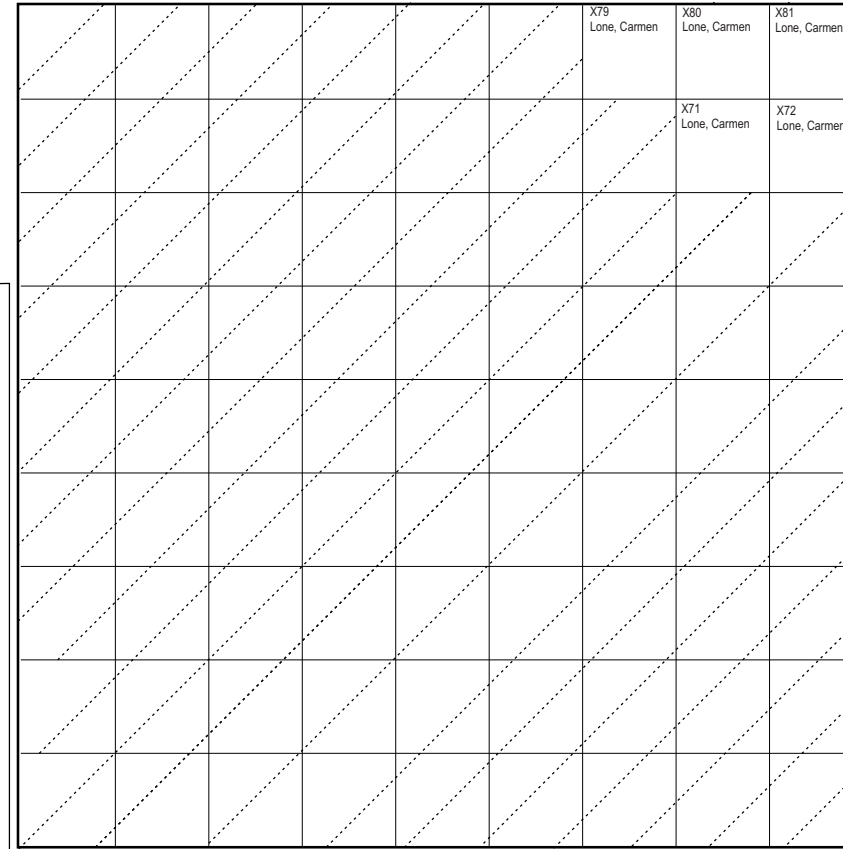

Walk Path

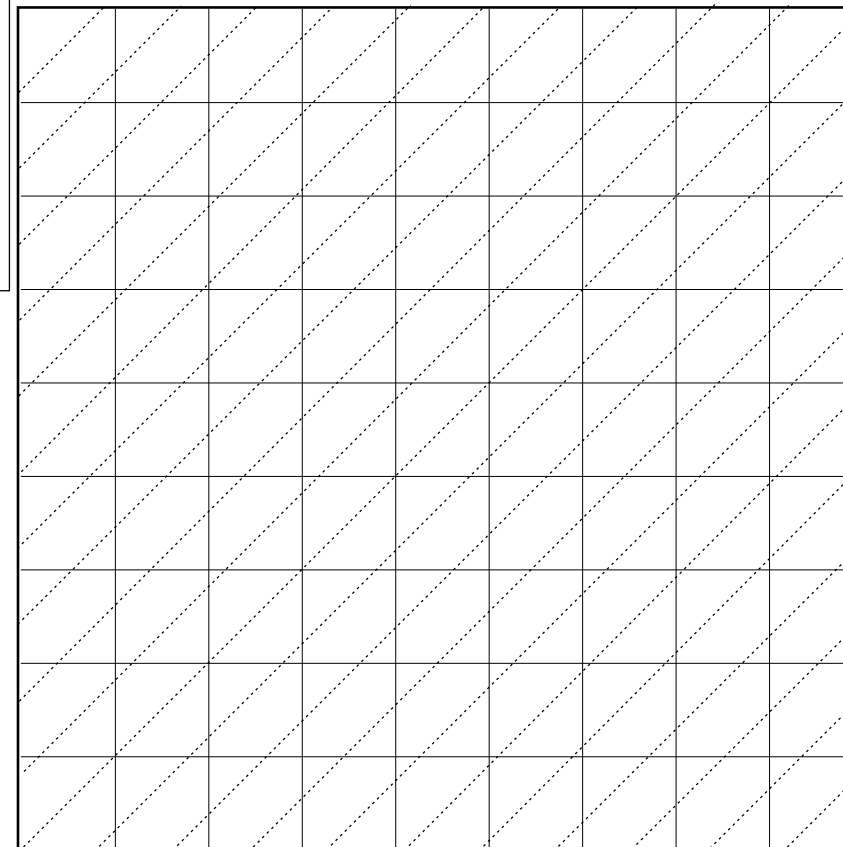

Section - Z

**DO NOT SELL LOTS
IN SECTION W/X/Z**

Each Lot is 3' x 3' (2 Graves)

Residents \$100.00 per lot

Non-resident \$150.00 per lot

No minimum lot purchase requirement

Existing Section C



Urn Section

REV 03.2010 LLC

Forest Hills Annex Urn Garden	
Urn Sections W-X-Y-Z	
NOTE: The scale, grave location and measurements shown are for general reference use only. This is not a site surveyed document.	Scale 1" = 3'
Sheet 8 of 8	
Copyright © 2010 by TOPOGRAPHIX, LLC	

Disclaimer: The contents of this map is based on documents and information supplied by the client and public satellite imaging. Accuracy of images is not suitable for engineering purposes. TOPOGRAPHIX® assumes no responsibility for it's content.