

Forest Hills Cemetery

Town of Bridgton, Maine

Plan View 2010

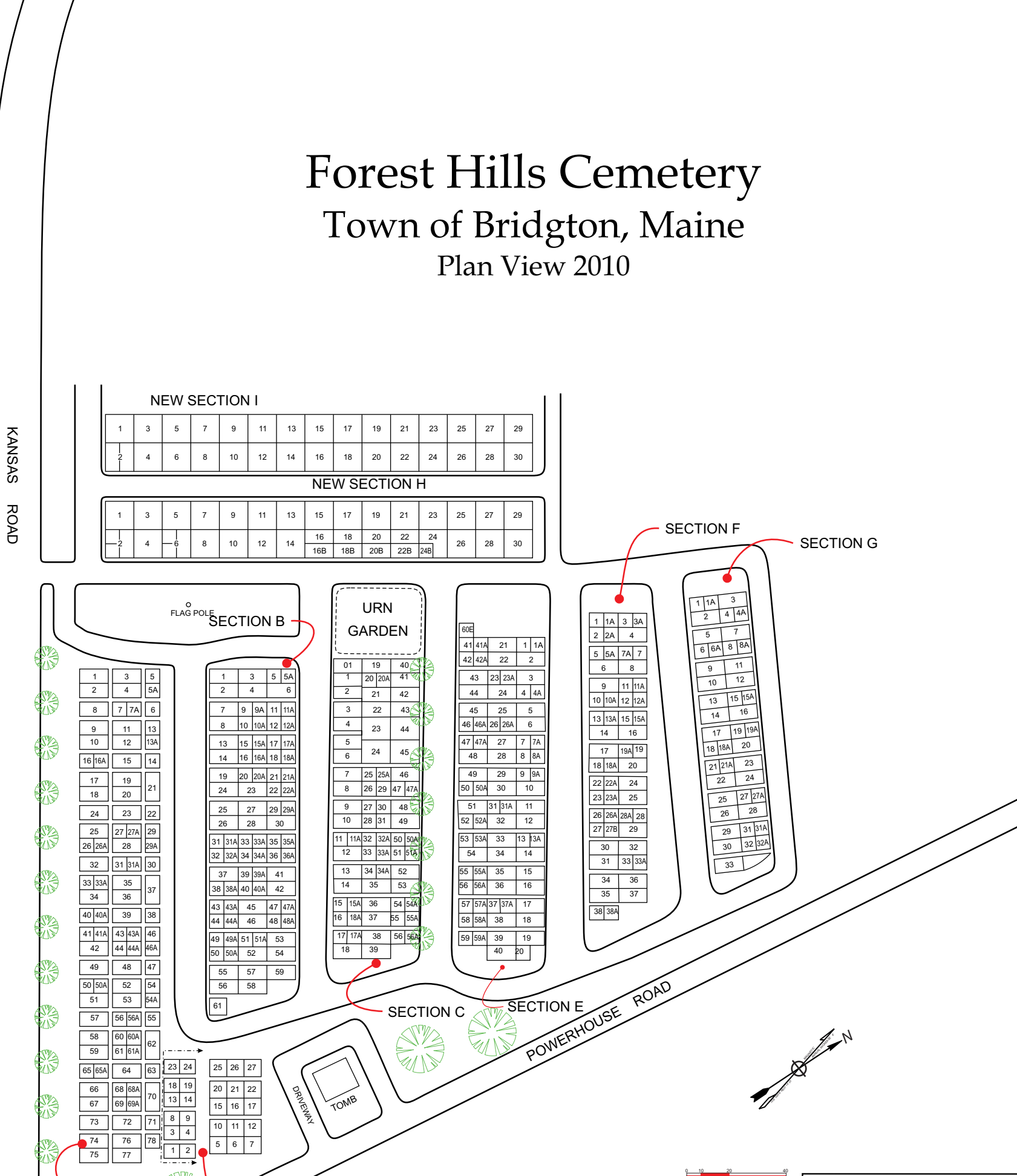

Original plan draw by:
Ray T. McDonald Surveyor
November, 1952

A	E
B	F
C	G
D	H

1992 Legend
N.S.: Not Sold
D.K.: Don't Know

Lot numbers 3, 5, 9, 11, 13, 15, 17, 19, 23, 25, 27, & 29 on Carnation Ave are to be divided into single graves as shown above

Names copied from previous plan.
July 13, 1992
R.C. Green, Jr

BOOK 39

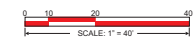

Disclaimer: The contents of this map is based on documents and information supplied by the client and public satellite imaging. Accuracy of images is not suitable for engineering purposes. TOPOGRAPHIX assumes no responsibility for it's content.

Forest Hills Cemetery

Plan View

NOTE: The scale, grave location and measurements shown are for general reference use only. This is not a site surveyed document.

Scale 1" = 40'

Sheet 1 of 8

Copyright © 2010 by TOPOGRAPHIX, LLC

PROPERTY LINE

CARNATION AVENUE

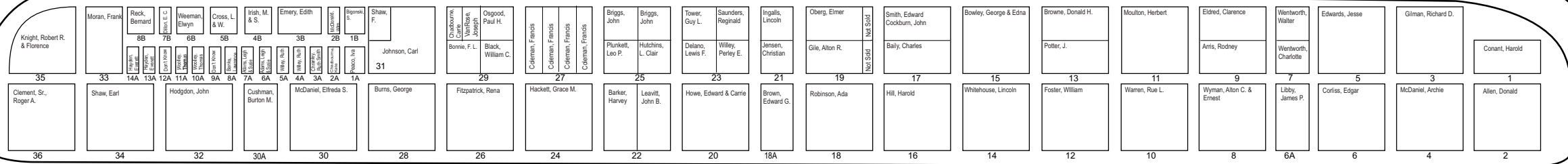

HYACINTH AVENUE

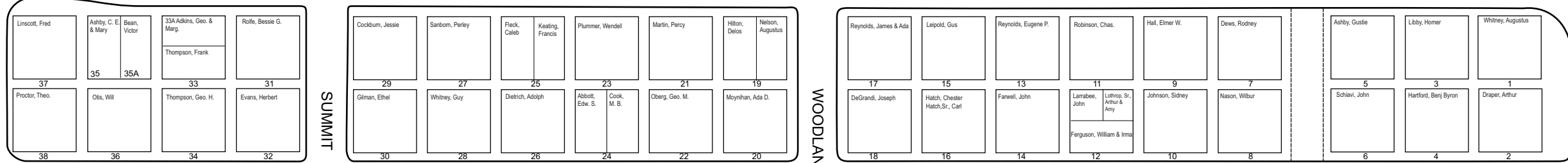

PRIMROSE AVENUE

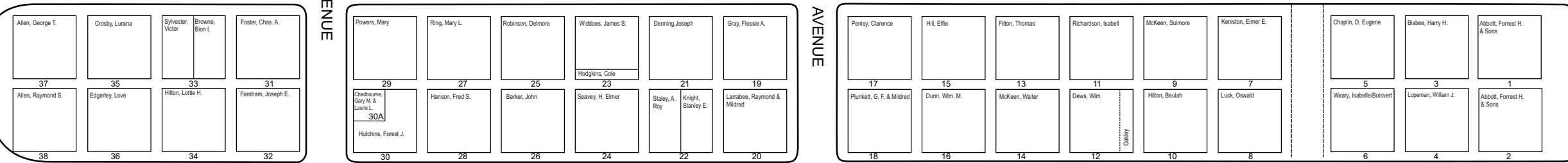

SMILAX AVENUE

SUMMIT AVENUE

WOODLAND AVENUE

FRONT AVENUE

KANSAS ROAD



Disclaimer: The contents of this map is based on documents and information supplied by the client and public satellite imaging. Accuracy of images is not suitable for engineering purposes. TOPOGRAPHIX® assumes no responsibility for it's content.

Forest Hills Cemetery	
Section View	
NOTE: The scale, grave location and measurements shown are for general reference use only. This is not a site surveyed document.	Scale 1" = 20'
Sheet 2 of 8	
Copyright © 2010 by TOPOGRAPHIX, LLC	

PROPERTY LINE

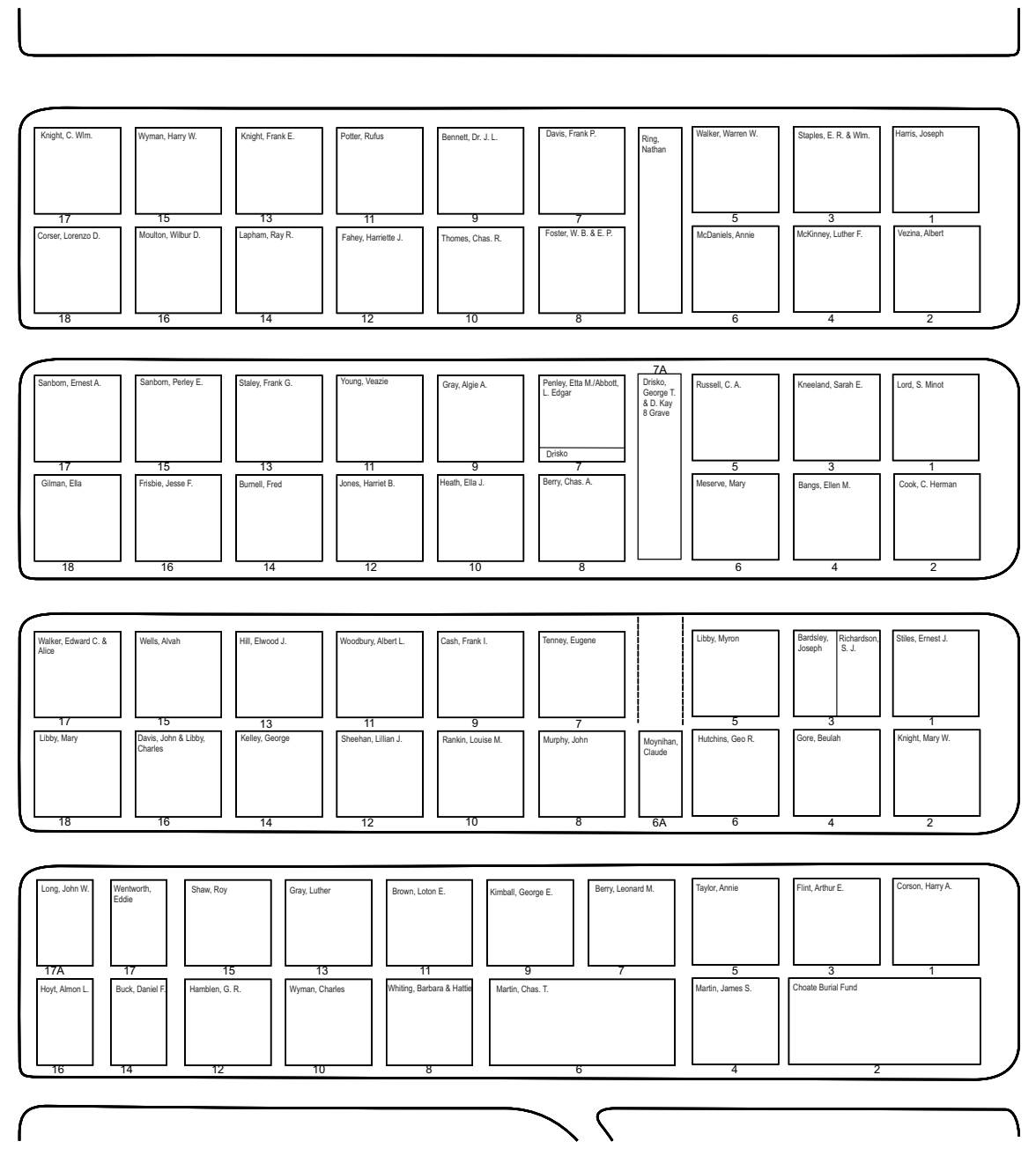
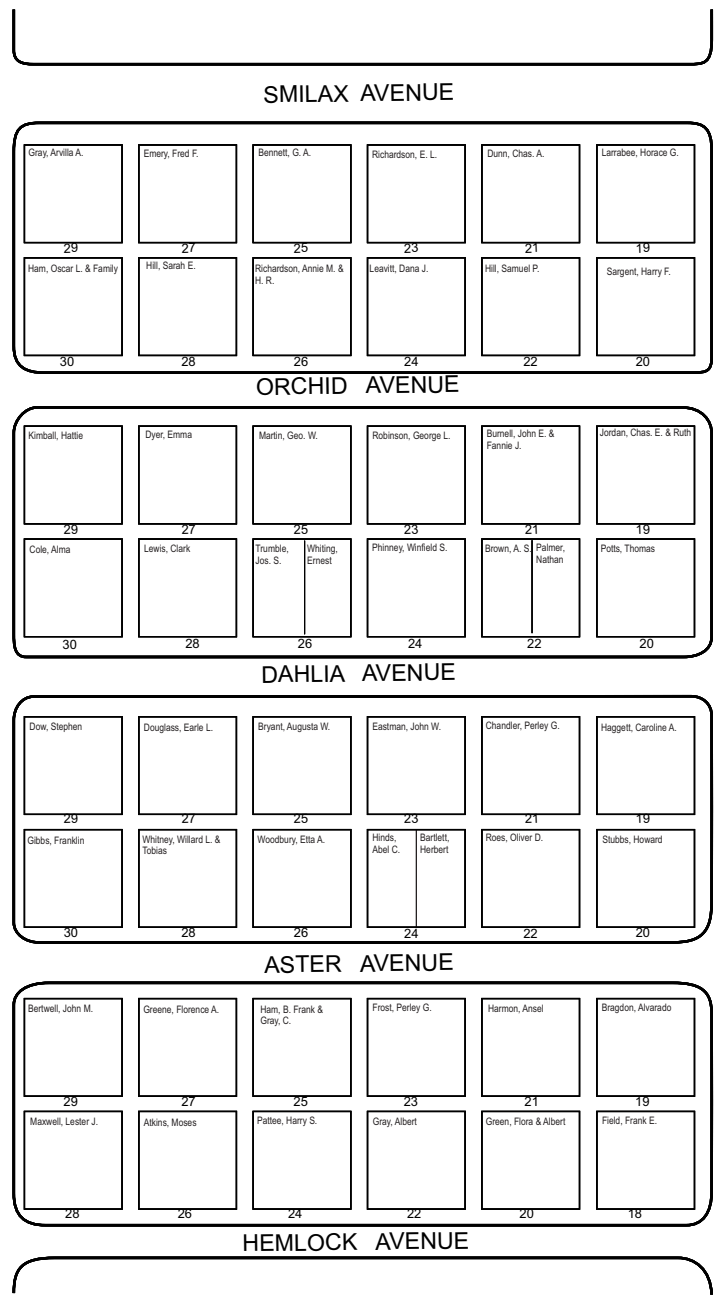
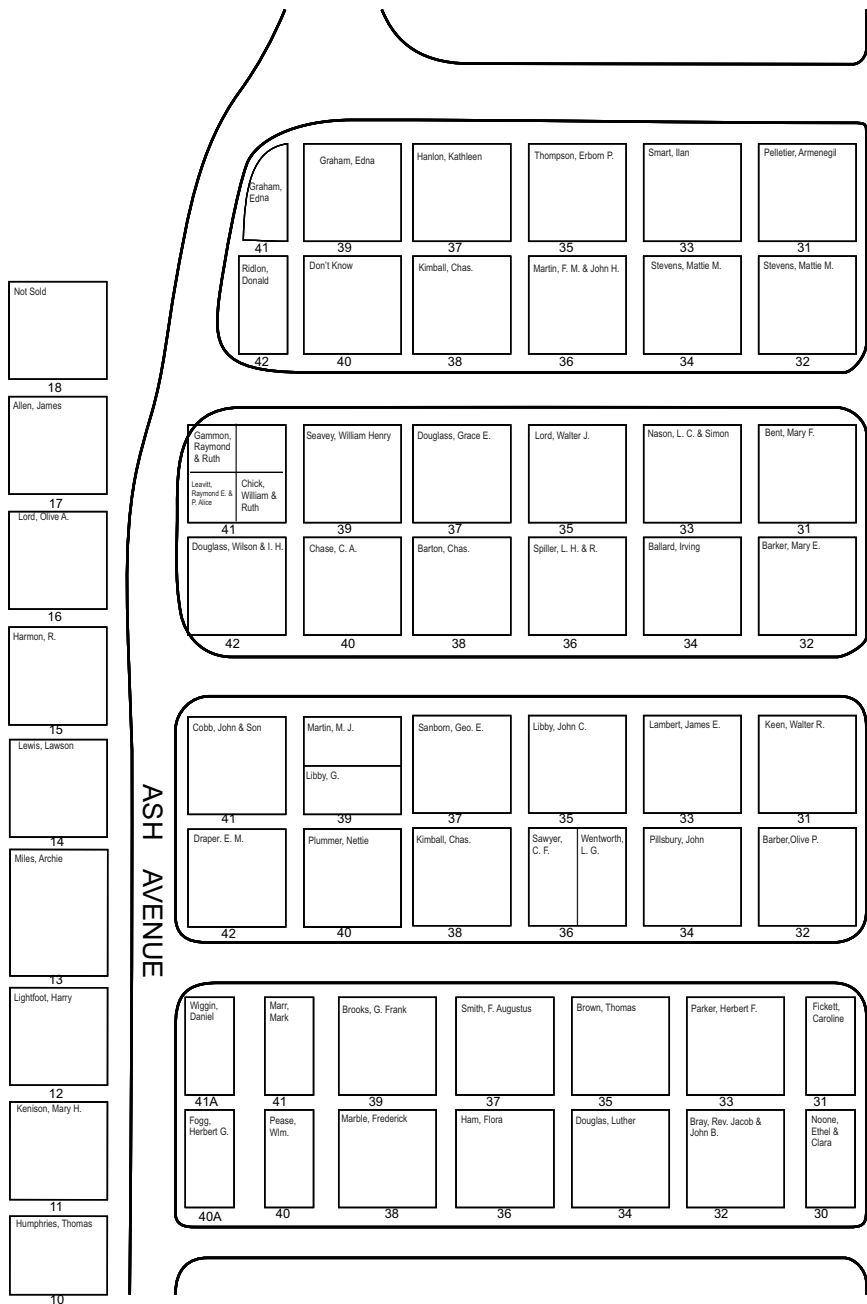

Disclaimer: The contents of this map is based on documents and information supplied by the client and public satellite imaging. Accuracy of images is not suitable for engineering purposes. TOPOGRAPHIX® assumes no responsibility for it's content.

Forest Hills Cemetery	
Section View	
NOTE: The scale, grave location and measurements shown are for general reference use only. This is not a site surveyed document.	Scale 1" = 20'
Sheet 3 of 8	
Copyright © 2010 by TOPOGRAPHIX, LLC	

PROPERTY LINE

- Humphries, Thomas
- 10
- Allen, Edward S.
- 9
- Allen, James B.
- 8
- Bowley, Linus
- 7
- Eastman, Roger
- 6
- Hatch, Ruth
- 5
- Allen, Arnold J.
- 4
- Tom

SUMMIT AVENUE

Carnell, Eben H.	Scribner, Allen P.	Walker, Asaph	Seavey, Frank W.	Paine, Adaline	Larabee, Frank M.
39	37	35	33	31	29
Hale, George F.	Douglass, Levi	Plummer, Freeman W.	Larabee, Geo. H.	Butlers, Levi	Stevens, Frank & Eva
40	38	36	34	32	30

HEMLOCK AVENUE

Mitchell, John, Rev.	Gleason, Micajah	Gibbs, Charles B.	Gibbs, Aaron	Smith, Parley W. & Alberta	Simpson, Frank B.	Barnett, Joshua F.
27	25	23	21	19	17	
Lewis, Nelson & Francis	Bentwell, Chas. E.	Hazen, Walter S.	Martin, Enoch	Smith, Lewis	Kimball, Wm. G.	
28	26	24	22	20	18	

WOODLAND AVENUE

Harry, Alfred E.	Duffee, Aidana	Hewson, William	Dodge, Richard	Brown, Theodore	
15	13	11	9	7	
Taylor, George W.	Pomeroy, Harold	Gray, Frank	Drowns, Edin L.	Edmunds, Vertude A.	Lugeman Jr. Wm.
16	14	12	10	8	8A

Berry, James E.	Chamberlain, E. C.	Halkett, J. Henry	Garrison, Jefferson C.
5A	5	3	1
Not Sold	Bacon, Eva & Mary	Carmen, Luther S.	Bennett, Reuben
6A	6	4	2

Small, William	Johnson, Cyrus C.	Hamblen, John G.	Scribner, David M.	Holt, William	Burnham, Eta M.	Wight, Geo. G.
39	37	35	33	31		29
Morrison, John	Ingalls, Herbert	Shaw, Wm. H.	Adams, Leon S.	Ross, John H.	Saunders, David C.	Parley, Geo. P.
40	38	36	34	32		30

FOUNTAIN AVENUE

Allen, Samuel R.	Davis, Sumner C.	Brown, Geo. H.	Libby, Wm. M.	Brown, Walter	Martin, Ada F.	Morrison, Wm. A.	Dickens, Fred
27	25	23	21	19	17		
Buck, Walter	Hicks, Garth D.	Davis	Chadborn, Philip	Bradstreet, Geo.	Howard, Barzila	Howard, B. Page	Larabee, Wm. H.
28	26	24	22	20	18		

Jenner, James	Trumbull, Carl	Brill, Gordon W. & John D.	MacDonald, Frank T.	Packard, George Henry
15	13	11	9	7
Wales, Joseph	Burnham, Nathan C.	Clark, Samuel D.	Burnham, Frank H.	Topham, William
16	14	12	10	8

Taylor, George	Keene, John	Corson, Walter
5	3	1
Iredale, J. H. & Harris, N. D.	Bennett, J. A.	Iredale, Mary E.
6	4	2

Hanson, Frank D.	Merrill, Austin P.	Merrill, Thatcher P.	Chaplin, David P.	Cheatham, John	
39	37	35	33	31	
Bacon, Geo. S.	Stone, Simon	Stone, John & Essie	White, Leander M.	Leavitt, Joseph S.	Kimball, Wm. S.
40	38	36	34	32	30

CHAPEL AVENUE

McDonald, Wm. M.	Hilton, Lizzie E.	Chase, Chas. H.	Freeman, Geo. W.	Newcomb, Geo. W.
25	23	21	19	17
Stevens, Della A.	Merrill, Amasa H.	Stevens, Berj. W.	Dodge, Nathan C.	Sylvester, Aaron
28	26	24	22	18

Potter, Charles	Hariman, Abel	Martin, Leonard	Iredale, William	Perry, William F.
15	13	11	9	7
Ballard, Josiah	Mellor, Richard	Fogg, Clara G.	Crockett, Daniel M.	Castle, John
16	14	12	10	8

Burns, Geo. E. & Annie	Clark, Allen P.	Allen, Isaac
5	3	1
Hazen, David P.	Proctor, Kenneth A.	Plummer, Orrin G.
6	4A	4

Paine, Fred	Baker, Theophilus & Cyrus	Gomersall, William	Keele, Joseph	Littlefield, Blanche B.
42	40	38	36	34
Douglass, Daniel & Samuel	Lord, Clayton S.	Blosson, Walter	Marcque, John A.	Kimball, John
43	41	39	37	35

OAK AVENUE

Taylor, H. H. & Sarah	Wigt, Ronell L.	Stedman, Wm. H.	Ingalls, Owen B.	Ross, Carsten
27	25	23	21	19
Foster, Aulda E.	Trumble, Walter	Balford	Fogg, James A.	Long, Walter D.
28	26	24	22	20

Webb, Isaac	Mellor, Joseph Thomas	Jennings, Chas.
17	15	13
Om B. Thompson	Pillsbury, Caleb	
10	8	

MAPLE AVENUE

Easton, Thomas N.	Manner, Frederick W.	Don't Know
5	3	1
Haskell, Wm. L.	Vince, James H. & Ellen	Whitney, Fred
6	4	2

MAPLE AVENUE

Foster, Aulda E.	Trumble, Walter	Balford	Fogg, James A.	Long, Walter D.	Boon, Herbert H.
21	19	17	15	13	11
Howard, Napoleon B.	Foster, J.	Waring, Alexander	Cross, Elie	Long, Frank	Richardson, A. M.
30	28	26	24	22	20

Nicholson, Geo. Knight	Jackson, James
7A	5A
Douglass, Lincoln	Douglass, Geo. W.
9	7
Douglass, Earl	Saunders, Wm. P.
18	16
Not Sold	
16A	

MAPLE AVENUE

Robinson, Greenleaf	Chadbourne, Lyman B.	Burnham, Albion H.
5	3	1
Gibbs, Edward A.	Caswell, Willard M.	Webb, Isaac S.
6	4	2

BIRCH AVENUE

Douglass, Albert	Brown, Chas. W.	Winstow, C. W.	Weymouth, Stephen	Plaker, Joseph P.	Spruiel, Chas.	Green, Granville P.	Green, Abrizo	Gardner, Jerry W. & Joan	Scotchard, Rowana	Field, John	Not Sold	Don't Know
33	31	29	27	25	23	21	19	17	15	13		11

BIRCH AVENUE

Wills, Stanley P.	Pennell, Clarence R.	Woolley, LaForest
10A	8A	8
Allen, Jr., Robert		
2	3	
10		

MAPLE AVENUE

Easton, Thomas N.	Manner, Frederick W.	Don't Know
5	3	1
Haskell, Wm. L.	Vince, James H. & Ellen	Whitney, Fred
6	4	2

GLEN AVENUE

Taylor, Geo. & Arty, Charles	Green, Geo. S. & Juna	Irish, Chas. H.
5	3	1
Edwards, Jean	Graffam, Willard C.	Owens, Geo. W.
6	4	2

BIRCH AVENUE

McCormick, Harvey	Buswell, John	Walker, Edward	Trush, A.	Unknown	Reynolds, James	Leighton, D. H.	Not Sold
9A	9	7A	7	5	3	1	1A

BIRCH AVENUE

McComick, Harvey	Buswell, John	Walker, Edward	Trush, A.	Unknown	Reynolds, James	Leighton, D. H.	Not Sold
9A	9	7A	7	5	3	1	1A



Forest Hills Cemetery

Section View

NOTE: The scale, grave location and measurements shown are for general reference use only. This is not a site surveyed document.

Scale 1" = 20'

Sheet 4 of 8

Copyright © 2010 by TOPOGRAPHIX, LLC

Disclaimer: The contents of this map is based on documents and information supplied by the client and public satellite imaging. Accuracy of images is not suitable for engineering purposes. TOPOGRAPHIX assumes no responsibility for it's content.

KANSAS ROAD

75 Medbury, Sawyer E. & Elizabeth I.	74 Medbury, Sawyer E. & Elizabeth I.	73 Potts, Hattie E.	67 Cross, Eleanor M. & Eastman	66 Cross, Eleanor M. & Eastman	65 Thomas, David R. & Kathryn H.	59 Clements, Benjamin R. & Ruth C.	58 Clements, Benjamin R. & Ruth C.	57 Kimball, Doris G.	51 Mowatt, Sr. Arthur	50 Rebok, Shelbourne	49 Parsons, Ernest G.	42 Morgan, Evelyn G.	41 Wood, Arlene M. & Edna C.	40 Widon, Grace G.	34 Ridon, William	33 Nilson, Roy S.	32 Cushman, Sr. Guy B.	26 Browning, J. Douglas & Shirley L.	25 Gardner, Arnold A.	24 Fleck, C.	18 Pike, Sr., Frank H.	17 Pike, Sr., Frank H.	16 Klackner, George & Ernestine	10 Crosby, Leon & Mildred	9 Crosby, Leon & Mildred	8 O'Brien, Lena A.	2 Swanson, John H. & Elsa B.	1 Swanson, John H. & Elsa B.
77 Clark, Lonelle J. & Robert S.	76 Hogan, Cecil	72 Thompson, A.	69 Hanley, John E.	68 Brooks, Barbara	64 Wile, John D. & Mary E.	61 Hansen, H.	60 Stone, Pauline	56 Graffam, James & Eliza	53 Boyd, David S.	52 Shaw, Lawrence R.	48 Larabee, Beatrice H.	44 Keene, Harmon B.	43 Stevens, Hannah	39 Allen, Sr., Lawrence F.	36 Pettit, Lawrence G. & William R.	35 Perry, J. R. & Katherine M.	31 Cobb, Roger M.	28 Davis, Roger I. & Ellen F.	27 Potter, Fernando M.	23 Graham, Albert	20 Mayberry, Ernest H. & Hazel B.J.	19 Ricker, Grace A.	15 Phelps, R. S.	12 Barker, Clifford H. & Margaret	11 Miller, Kenneth & Margaret	7 Smith, Etta E.	4 Wagner, Isaiah	3 Wagner, Isaiah
78 Smith, Mabel O.	71 Wilkins, Marion P.	70 Hoover, Willis A. & Myrtle E.	63 Hatch, Marilyn	62 Hatch, Marilyn	55 Thompson, Russell W. & Velma D.	54A Hatch, Carl & Doris	54 Loperman, Arthur & Beulah	47 Benjamin, Frances Hart	46A Douglas, Linwood	46 Burnell, I. Lincoln & Bernice	38 Dubreuil, George W. & Ethlyn M.	37 Hardy, Edith	30 Reynolds, Marie R. & Vivian H.	29A Palma, Frank & Mollie	29 King, George R. & Almeda M.	22 Smith, Raymond Y.	21 Allen, Alvarado & Lillian	14 Douglas, Max E. & Virginia M.	13A Barker, Clifford H.	13 Hains, Leo J. & Gladys E.	6 O'Brien, Donald E. & Phyllis J.	5A Gagnon, Alida	5 Oamond, Alice R.					

SECTION A

1 Morrison, Earl & Jennifer	3 Smith, Bruce	8 Nowell, Barbara J.	13 Sirois, Romeo	18 Rolfe, Michael	23 Smith, A.
2 Morrison, Larry & Evelyn	4 Salye, Harold W. & Josephine	9 Nowell, Barbara J.	14 Smith, Curtis	19 Stone, M.	24 Uhyk, Jeanne

5 Morrill, Roger & Judy	10 Cross, Milton & Betty	15 Rehn, Harry	20 Cannell, Warren & Dorothy	25 Morgan, George & Mildred
6 Gargant, Thurston & Josephine	11 Gargant, Thurston & Josephine	16 Durfee, Curdilo	21 Cannell, Warren & Dorothy	26 Stuart, Kenneth & Phoebe
7 Prentice, Sheldon & Patricia	12 Prentice, Sheldon & Patricia	17 Bryant, Keith	22 Cannell, Warren & Dorothy	27 Stuart, Kenneth & Phoebe

SECTION D

POWERHOUSE ROAD

DRIVEWAY

TOMB

61 Clemons, LeRoy	56 Stevens, Lois M.	55 Stevens, Lois M.	50 Newcomb, Gertrude	49 Haggitt, Jeannette	44 Blanchard, Catherine T.	43 Stackhouse, June	38 Chadbourne, Delmar & Phyllis	37 Cadman, Gwendolyn	32 Burkusky, Anne E. & Jerome Richard & V. Anne	31 Burkusky, Anne E. & Jerome Richard & V. Anne	28 Richardson, H. Dale	25 Richardson, H. Dale	24 Gray, David F. & Dorothy A.	19 Gray, David F. & Dorothy A.	14 Allen, Stanley E. & Victoria A.	13 Macdonald, Roger W.	8 Macdonald, Roger W.	7 Macdonald, Roger W.	2 Gallinari, Antonio	1 Gallinari, Antonio	
58 Stevens, Lois M.	57 Stevens, Lois M.	52 Diller, David	51 Shaw, Robert & Hazel	48 Cardosi, Anna	45 Cardosi, Anna	40 Disko, Arthur	39 Sinclair, Violette	34 Fitch, Michael	33 Staley, Delma	32A Staley, Delma	28 Durkin, William	27 Durkin, William	23 Gray, David F. & Dorothy A.	20 Top. Clara & Robert	16 Douglas, Max E.	15 Richardson, L.	10 Halvorsen, Kaare	9 Lane, Nancy	4 McNeil, Jr., Samuel F.	3 McNeil, Jr., Samuel F.	
59 Roberts, Elizabeth & Mildred	54 Graffam, Wayne R. & Kathy	53 Harmon, Eben	48 Libery, El	47 Rutana, Ruth E. & Victor W.	44A Knight, G.	43A Croteau, Thelma E. & Floyd C.	40A Mitchell, William C.	39A White, Earl T. & Jean E.	34A Fitch, Claudia	33A Gilbert, George F.	30 Smith, Carlton & Phyllis	29 Smith, Carlton & Phyllis	22 Wheaton, Ruth	21 Wheaton, Ruth	18 Beech, Nora. Robert & Helen	17 Edson, Chesley	12 Fadden, Reginald J. & Edna L.	11 Fadden, Reginald J. & Edna L.	6 Clement, Fred W. & Shirleyann	5 Doney, Bertha G.	
48A Flint, Edward & Constance	47A Vachowski, Carleen	42 Trumble, Leamon & Frances	41 Brill, Stephen	38 Moore, Paul E. & Trippi, A.	35 Carr, Arthur & Helen	34 Doyle, William L.	33 Moore, Paul E. & Trippi, A.	32A Moore, Paul E. & Trippi, A.	31 Moore, Paul E. & Trippi, A.	30 Moore, Paul E. & Trippi, A.	29 Moore, Paul E. & Trippi, A.	28 Moore, Paul E. & Trippi, A.	27 Moore, Paul E. & Trippi, A.	26 Moore, Paul E. & Trippi, A.	25 Moore, Paul E. & Trippi, A.	24 Moore, Paul E. & Trippi, A.	23 Moore, Paul E. & Trippi, A.	22 Moore, Paul E. & Trippi, A.	21 Moore, Paul E. & Trippi, A.	20 Moore, Paul E. & Trippi, A.	19 Moore, Paul E. & Trippi, A.

SECTION B

18 Allen, Gail	17 Van Rose-Hubbard, Charlotte	16 Morrissau, William L.	15 Brown, Edmund	14 Bosworth, John E.	13 Woodruff, Archibald M.	12 Thurlow, Fred C. & Verma M.	11 Brackett, Frances	10 Davis, Paul V. & Marguerite B.	9 Davis, Paul V. & Marguerite B.	8 Berg, John J.	7 Allen, Jr., Lawrence F. & Eleanor	6 Mowatt, Camilla	5 Mowatt, Gordon	4 Mowatt, Sr. Harley H.	3 Gallinari, Paul	2 Gallinari, Joseph L. & Olga	1 Gallinari, Joseph L. & Olga	01 Staley, Robert & Debra
39 Barber, Stevens & Mary & Simmwell, Susan Thomas	38 Barber, Stevens & Mary & Simmwell, Susan Thomas	37 Harrison, Avina	36 Harrison, Avina	35 Barker, Edwin K. & Ruby	34 Cook, LinnMentl	33 Martin, Richard	32 Martin, Richard	31 Merrill, Roger & Louise	30 Mowatt, Cecil	29 Fitzcharles, William	28 Fitzcharles, William	24 Shepard, Alan & Marguerite	23 Shepard, Alan & Marguerite	22 Leland, William A. & Ellen	21 Porter, Michelle	20 Abrecht, William	19 Abrecht, Alan	
56 Griffith, Marlene & Robert	55A Phillips, Charles	54A Phillips, Chester	53 Lane, Arnold S. & Lois M.	52 Lane, Arnold S. & Lois M.	51 McAninch, Judy	50 Frazier, Stanley	49 Harnsford, Wesley & Phyllis	48 Julien, Claire	47 Franchek, J. Julien	46 Norton, Michael J.	45 Brant, Clifton	44 Brant, Clifton	43 Henson, Barbara	42 Barry, Marilyn	41 Barry, Harlan	40 Davis, Harlan		

SECTION C

FLAG POLE O

URN GARDEN



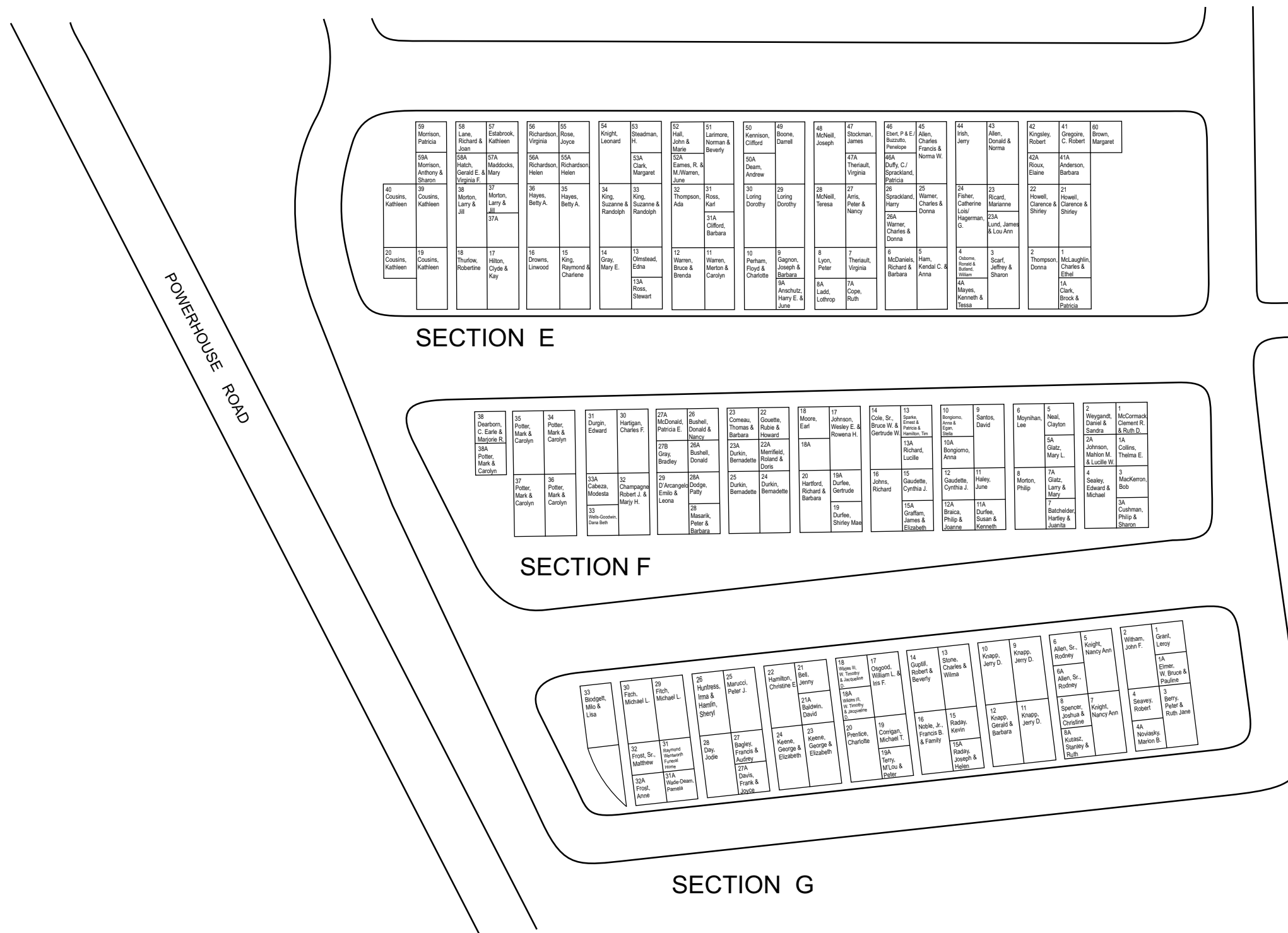

Disclaimer: The contents of this map is based on documents and information supplied by the client and public satellite imaging. Accuracy of images is not suitable for engineering purposes. TOPOGRAPHIX® assumes no responsibility for it's content.

Section - W

Section - X

PEARL AVENUE

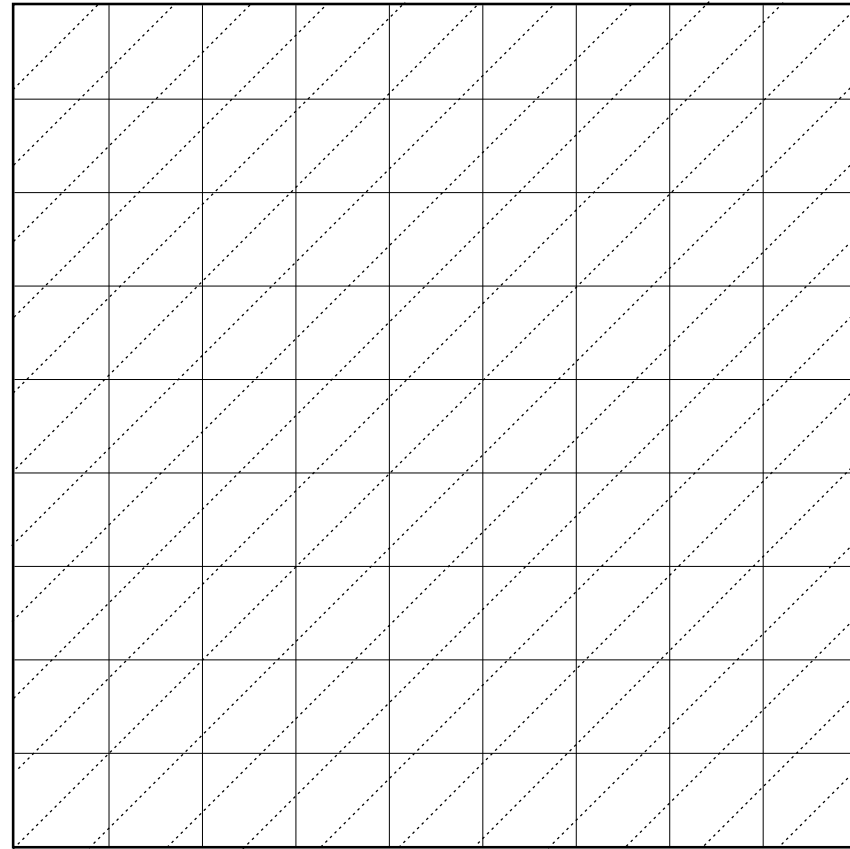

Walk Path

Reid, Heidi								Linscott, Patricia
Y73	Y74	Y75	Y76	Y77	Y78	Y79	Y80	Y81
Y64	Y65	Y66	Y67	Y68	Y69	Davis, Joyce & Bulley, Leon	Y71	Y72
Y55	Y56	Y57	Y58	Y59	Y60	Y61	Y62	Maczuba, Jan & Carol
Y46	Y47	Y48	Y49	Y50	Richards, Alma R.	Galles, Norma F. & Robert	Y53	Egan, Abigail
Y37	Y38	Y39	Y40	Y41	Y42	Y43	Y44	Y45
Y28	Y29	Y30	Y31	Y32	Y33	Y34	Y35	Henning, Carl & Doris
Y19	Y20	Y21	Y22	Y23	Y24	Y25	Y26	Y27
Y10	Y11	Y12	Y13	Y14	Y15	Y16	Y17	Y18
Eileen & Francis Russo		Chapman, Jr. George R. & Faylene M.		Adams, Cheryl				Angelo, Priscilla & Joseph W.
Y1	Y2	Y3	Y4	Y5	Y6	Y7	Y8	Y9

Walk Path

Sitting Area

Walk Path

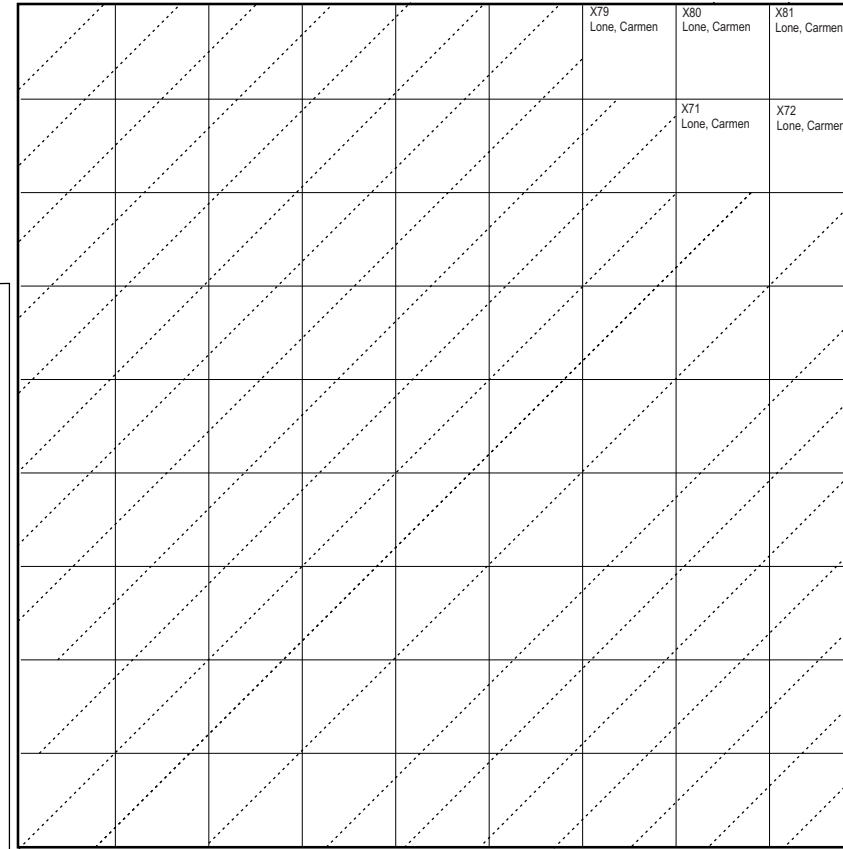

Walk Path

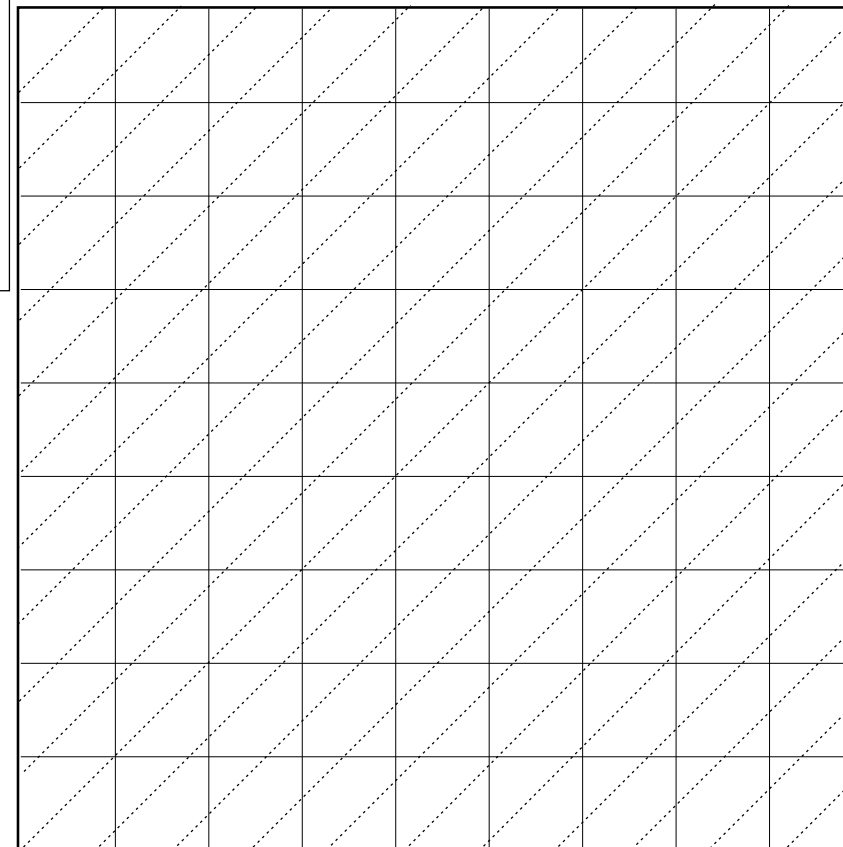

Section - Z

**DO NOT SELL LOTS
IN SECTION W/X/Z**

Each Lot is 3' x 3' (2 Graves)

Residents \$100.00 per lot

Non-resident \$150.00 per lot

No minimum lot purchase requirement

Existing Section C



Urn Section

REV 03.2010 LLC

Forest Hills Annex Urn Garden	
Urn Sections W-X-Y-Z	
NOTE: The scale, grave location and measurements shown are for general reference use only. This is not a site surveyed document.	Scale 1" = 3'
Sheet 8 of 8	
Copyright © 2010 by TOPOGRAPHIX, LLC	

Disclaimer: The contents of this map is based on documents and information supplied by the client and public satellite imaging. Accuracy of images is not suitable for engineering purposes. TOPOGRAPHIX® assumes no responsibility for it's content.